



Information from the owner's manuals of 2010 and 2011 is used. The location and function of fuses in cars produced at other times may differ.

Cigar lighter (power outlet) fuses in the KIA Cee'd are located in the Instrument panel fuse box (see fuses "C/LIGHTER" (Cigar lighter), "P/OUTLET" (Power outlet) and "RR P/OUTLET" (Rear power outlet)).

Table of Contents

Fuse box location

Instrument panel

Engine compartment

Assignment of the fuses in the Instrument panel

Assignment of the fuses in the Engine compartment

Fuse box location

Instrument panel



Engine compartment

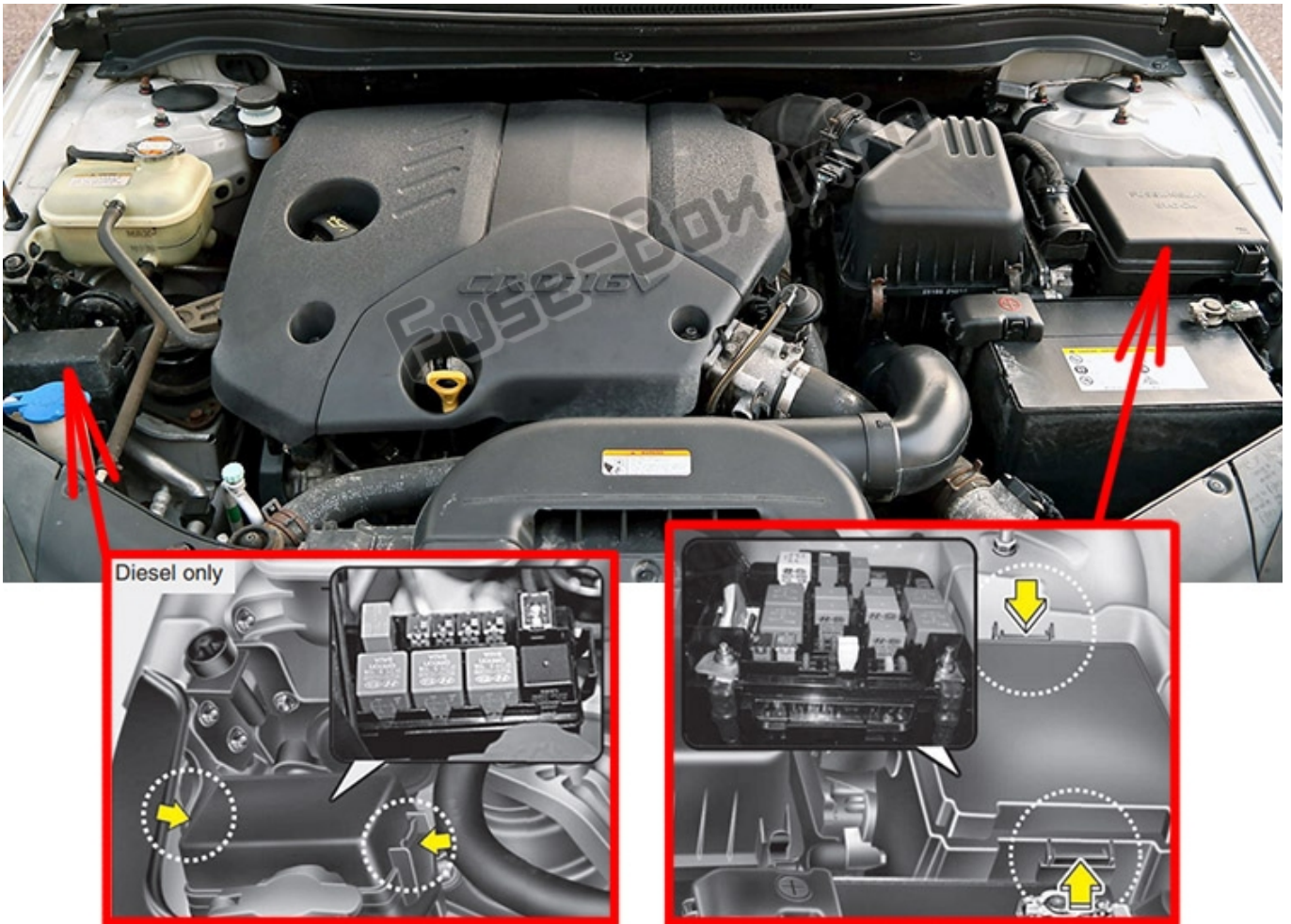

Inside the fuse/relay panel covers, you can find the label describing fuse/relay name and capacity. Not all fuse panel descriptions in this manual may be applicable to your vehicle.

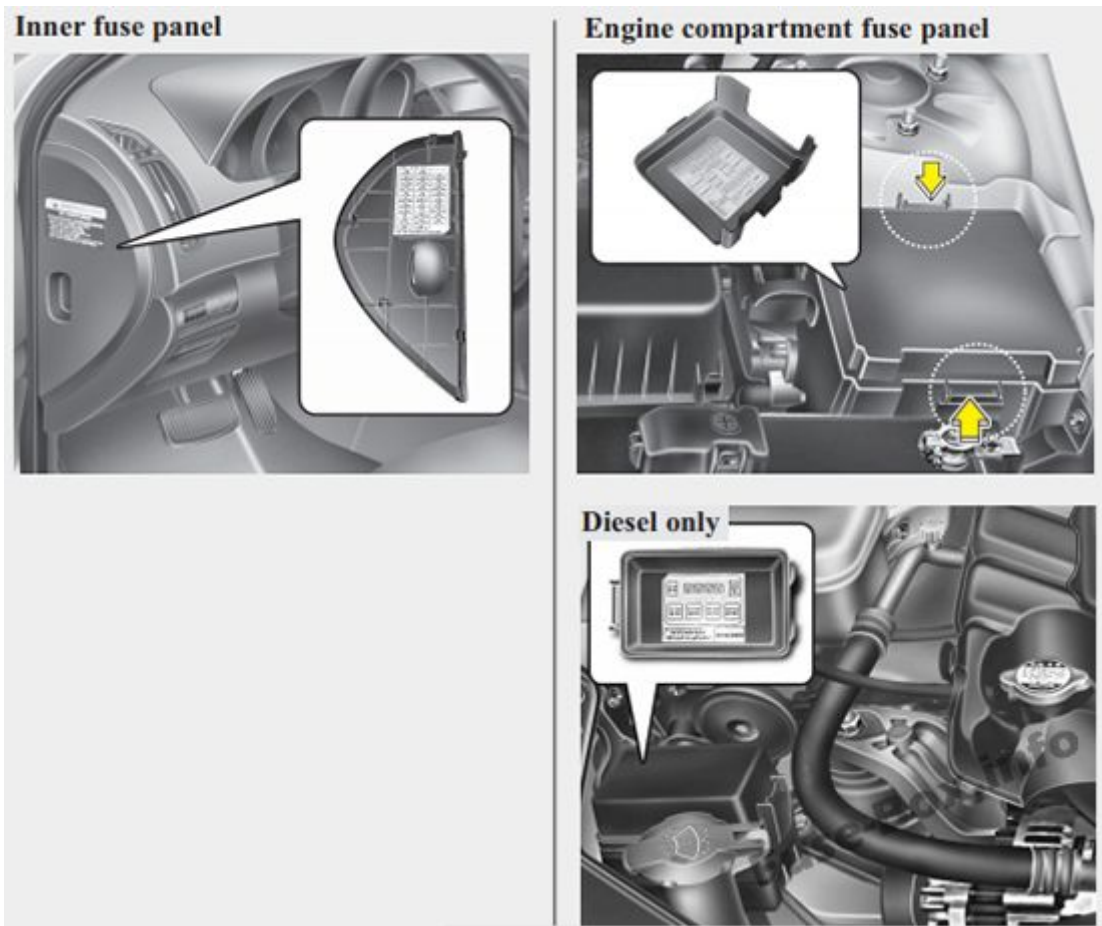

Assignment of the fuses in the Instrument panel

Advertisements

Description	Amp rating	Protected component
START	10A	Start motor solenoid
A/CON SW	10A	Air-conditioning system
HTD MIRR	10A	Outside review mirror defroster
SEAT HTR	15A	Seat warmer
A/CON	10A	Air-conditioning system

Description	Amp rating	Protected component
HEAD LAMP	10A	Headlight
FR WIPER	25A	Wiper (front)
RR WIPER	15A	Rear wiper
DRL OFF	-	Daytime running light off
RR FOG	10A	Fog light (rear)
P/WDW (LH)	25A	Power window (left)
CLOCK	10A	Clock
C/LIGHTER	15A	Cigar lighter
DR LOCK	20A	Sunroof, Door lock/unlock
DEICER	15A	Front deicer
STOP	15A	Stop lamp switch
ROOM LP	15A	Room lamp
AUDIO	15A	Audio, Trip Computer
T/LID	15A	Tailgate, Folding mirror
SAFETY P/WDW RH	25A	Safety power window (right)
SAFETY P/WDW LH	25A	Safety power window (left)
P/WDW(RH)	25A	Power window (right)
P/OUTLET	15A	Power outlet
T/SIG	10A	Switch module
A/BAG IND	10A	Air bag indicator
CLUSTER	10A	Cluster, TPMS
A/BAG	15A	Air bag

Description	Amp rating	Protected component
TAIL RH	10A	Tail light (right)
TAIL LH	10A	Tail light (left)
MDPS	15A	Motor driven power steering
RR_P/OUTLET	15A	Rear power outlet

Advertisements

Assignment of the fuses in the Engine compartment

Description	Amp rating	Protected component
B+ 2	50A	I/P Junction Box (S/ROOF 20A, DR LOCK 20A, STOP 15A, T/LID 15A, Power Connector - ROOM 10A, AUDIO 15A, DEICER 15A, RR P/OUTLET 15A)
B+ 1	50A	I/P Junction Box (Relay - Power Window, Fuse - P/WDW LH 25A, P/WDW RH 25A, HAZARD 15A), RR FOG 10A, Relay - Tail Lamp, Fuse - TAIL LH 10, TAIL RH 10A)
C/FAN	40A	C/Fan Relay (High), C/Fan Relay (Low)
ALT	150A	Alternator
ABS 2	20A	ABS Control Module, ESP Control Module
ABS 1	40A	ABS Control Module, ESP Control Module
RR HTD	40A	I/P Junction Box (RR HTD RLY)
BLOWER	40A	Blower motor

Description	Amp rating	Protected component
MDPS	80A	Motor Driven Power Steering module
IGN 2	40A	Ignition Switch (IG2, START)
ECU 4	20A	ECU, ISA, EEGR
F/PUMP	15A	Fuel Pump Relay
IGN 1	30A	Ignition Switch (IG1, ACC)
H/LP	20A	Head Lamp (High)
F/FOG	15A	Front fog
HORN	15A	Horn
H/LP LO RH	10A	Head Lamp RH
H/LP LO LH	10A	Head Lamp LH, Instrument Cluster (Low Beam Indicator)
ABS	10A	ABS Control Module, ESP Control Module
ECU	10A	Diesel-TCM, ECU, TCU Gasoline - ECM, PCM, ECU, PCU
ECU 3	10A	ECU
ECU 2	10A	ECU
ECU 1	30A	Diesel - ECM, ECU,TCU Gasoline - ECM, PCM, ECU, PCU
INJ	15A	Diesel - Electrical EGR Actuator, VGT Actuator Gasoline - Injector #1 - #4
SNSR 2	15A	Diesel - A/Con Relay, C/Fan Relay (High/Low), Lambda Sensor, Air Heater Relay, Immobilizer; Gasoline - A/Con Relay, C/Fan Relay (High/Low), Camshaft Position Sensor, Canister Purge Solenoid Valve, Oil Control Valve, Oxygen Sensor Up/Down, Immobilizer
SNSR 1	10A	Diesel - A/Con Relay, C/Fan Relay (High/Low), Lambda Sensor, Air Heater Relay, Immobilizer;